



ICL-IP Bitterfeld GmbH

Denis Przybylski/ Site Manager

May 23rd 2019

Israel / German Chamber of Commerce

Visit Germany – Bitterfeld 23rd of May

Agenda

1. ICL overview
2. ICL-IP Bitterfeld GmbH
3. Industry cluster and public relations
4. Risk management - Seveso III-Directive



1 Israel Chemical Limited - overview

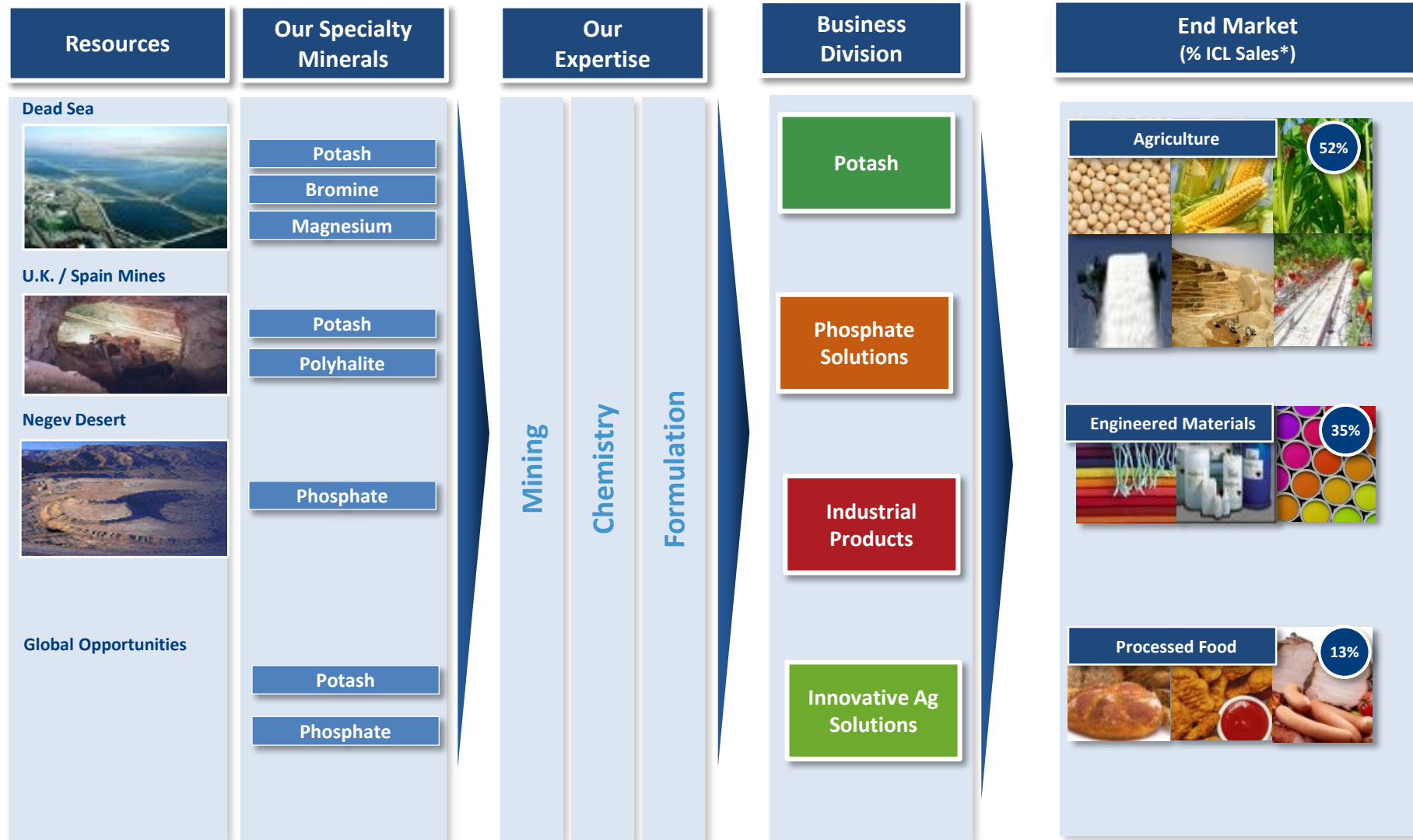

2 ICL-IP Bitterfeld Plant (2019)

- 69 employees and 6 apprentices
- Production and sales of:
 - Flame retardants (Fyrol)
 - Engineering resin FR (Fyrolflex)
 - Phosphorus Trichloride (PCl_3)
 - Phosphorus Oxychloride (POCl_3)
 - Phosphorous Acid (H_3PO_3)
 -
- Supply into markets in Europe, Asia, America



3 IPB units

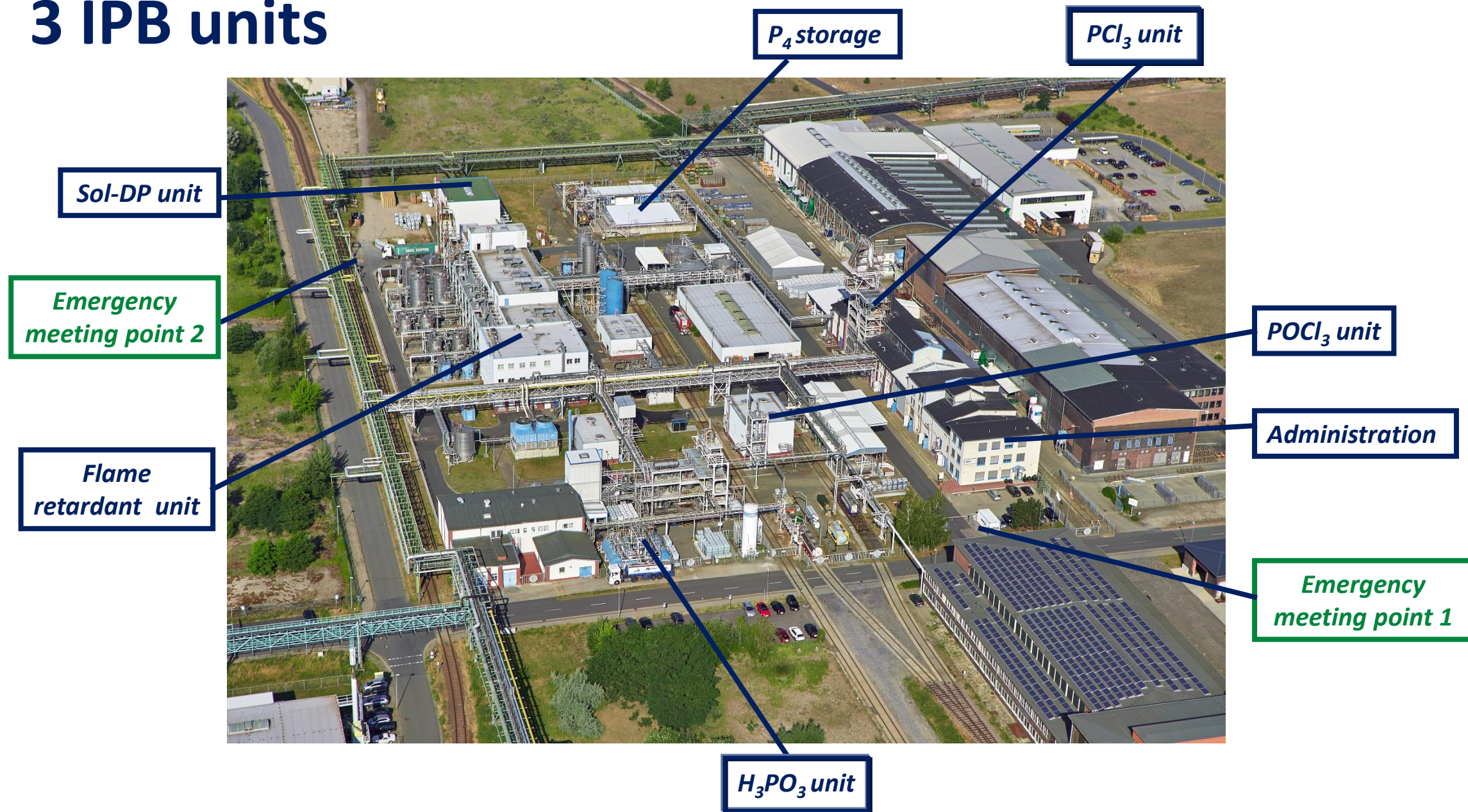

ICL-IP Bitterfeld Plant

- ✓ Modern and efficient processes
- ✓ Proprietary Technology
- ✓ Low cost
- ✓ Manufacturing capabilities
- ✓ Continuous and batch production
- ✓ 3 product families
- ✓ Infrastructure part of the chemical complex
- ✓ Backward integrated to P4



3 Industry cluster and public relations

VCI – Association of Chemical Branch

Industry Cluster

- VCI represents the politico-economic interrests of German chemical/pharma companies vis-avis important target groups: politics, authorities, other industries ...
- Committees, expert groups, working parties develop positions of the industry in topical fields (plant safety, energy, climate protection, legal affairs, ...)
- ICL has representatives in the VCI working parties

Public Relations / communications

- Chemical companies often do regional activities – protecting environment
- ICL working together with professional media partner Unicepta, espacially in case of crises communication (more companies in Bitterfeld doing the same)

4 Risk management ICL-IP Bitterfeld

Seveso-III-Directive

- Operates under Ordinance of Hazardous Incidents „Störfall-Verordnung“ which requires an emergency organization plan
- System installed to check: regular supervision , control and maintenance of facilities and installations PLUS employee training
- Must have: Safety Report document „Sicherheitsbericht“, Emergency Response Plan, a concept for preventing hazardous incidents „Sicherheitsbericht“, safety management system and instructions for employees
- In case of emergency: clear processes and informations flow are defined in Emergency Response Plan
- Alarm server in place, to distribute automatically necessary informations to relevant targets

4 Risk management ICL-IP Bitterfeld

Local activities / support

- Independent emergency shutdown system (ESD) with independent control for functionality and critical functions as defined by sites safety integrity level (SIL)
- Installed backup with a power station with 300kW with an emergency diesel generator – only for safe and friendly shutwon capacity, not for keep production still running
- Fire fighting plan from the professional fire brigade of the Chemical Park (3 permanently stations in the whole Chemical Park) – time to IPB <3minutes
- Voluntary fire brigades are as well available if needed.
- Provides as well technical assistance (hydrants, fire extinguisher, ...)

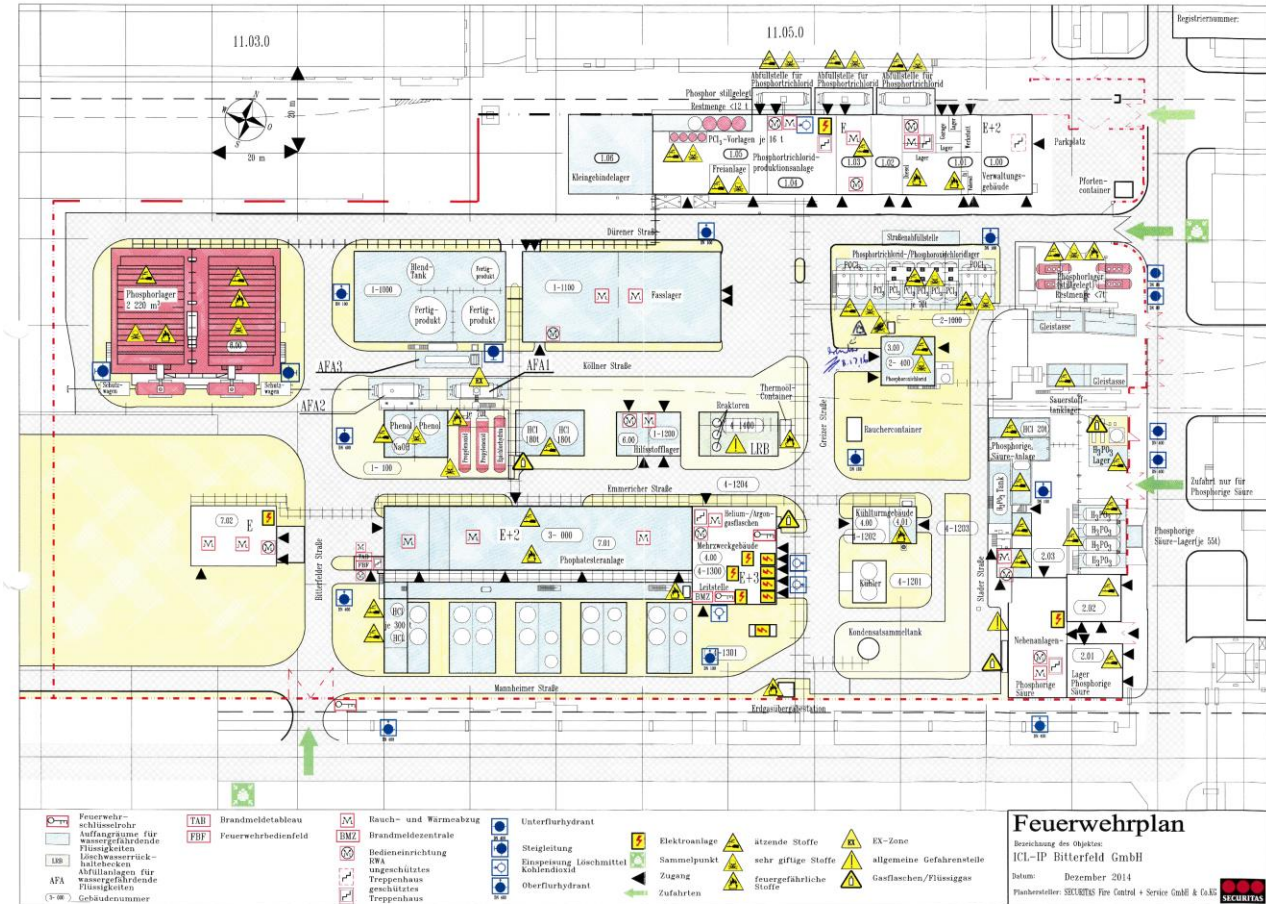

4 Risk management ICL-IP Bitterfeld

Local activities / support

- Internal water supply where hazardous chemicals are provided with retention for extinguishing water
- Fire fighting water lines are independent with a diameter of 500 and 250mm
- Checkup of the pipelines from professional fire brigade Securitas

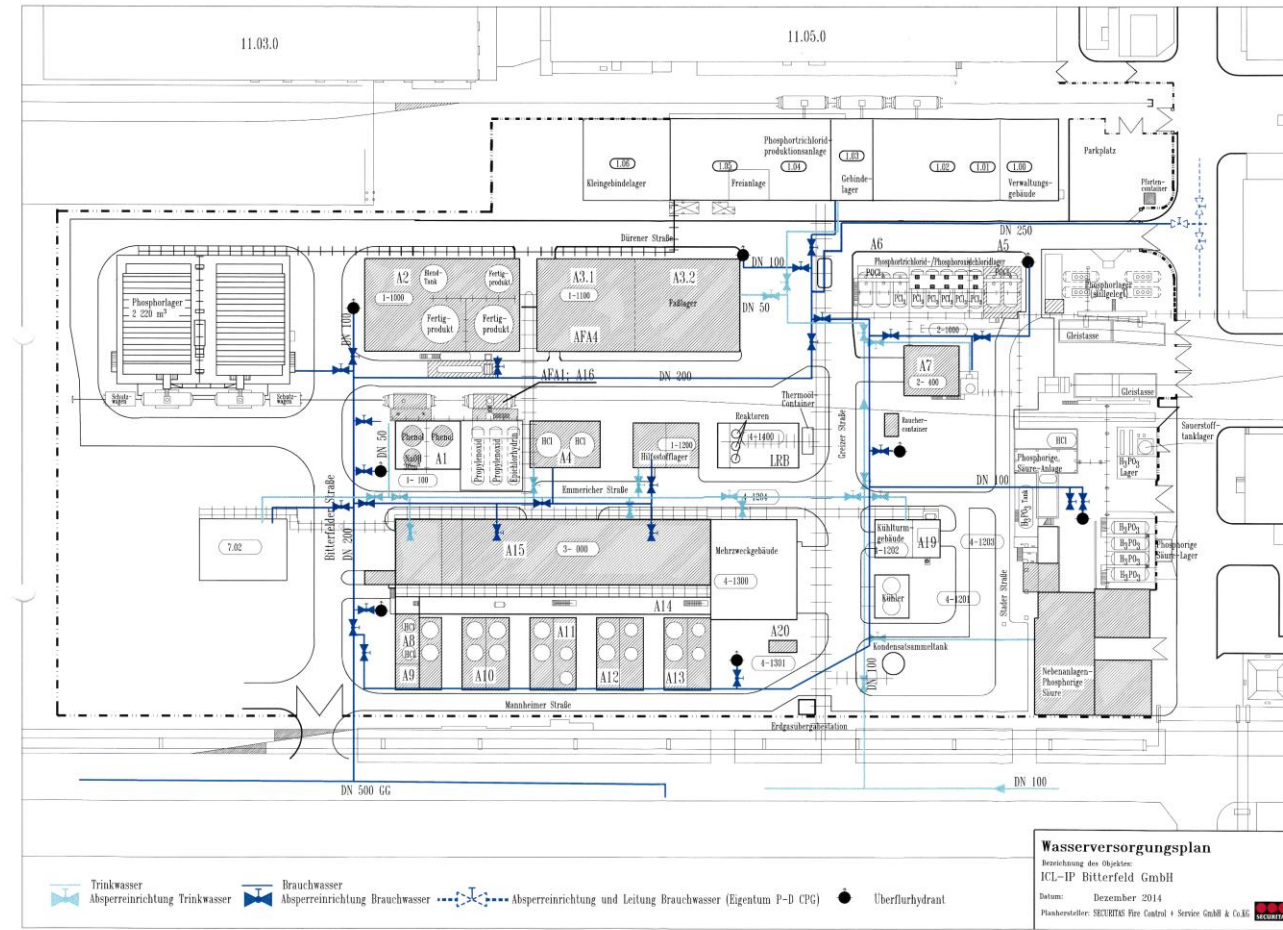

4 Risk management ICL-IP Bitterfeld

Local activities / support

- On the maps in are circles for the expansion areas of the main hazardous materials on the site for explosions
- 700m → Propylenoxyd
- 880m → Chlorine
- 2060m → Hydrochlorine Acid
- These cases are managed and detailed discribed in the safety report

Hazardous areas

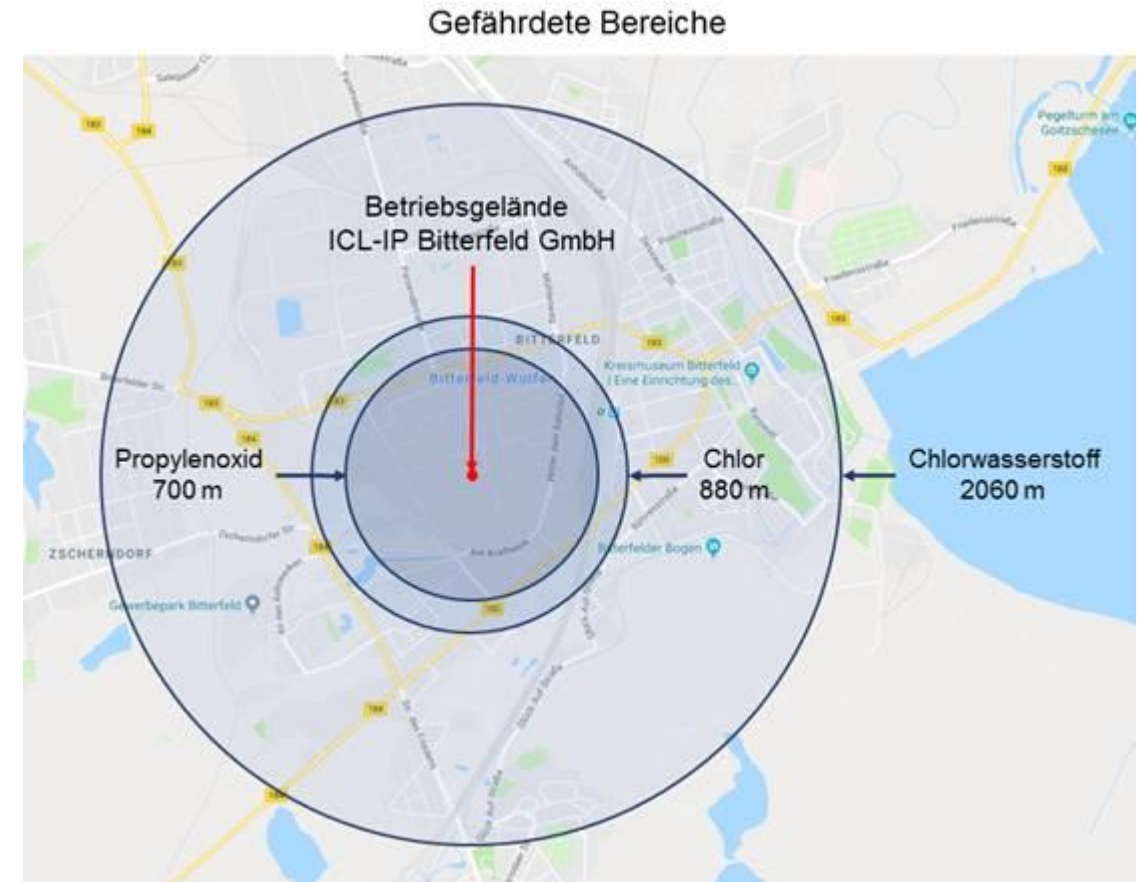



THANK YOU

Visit us at www.icl-group.com